

425 *hts*



propulsion

**TWIN VOLVO PENTA IPS 500
WITH JOYSTICK
[06-370 HP - 272 kW]**

*cruising speed** **28 KNOTS**

*maximum speed** **32 KNOTS**

<i>length overall</i>	44' / 13.46 M
<i>hull length</i>	39' 04" / 11.99 M
<i>beam</i>	12' 10" / 3.91 M
<i>dry weight</i>	27,400 LB / 12,425 KG
<i>maximum load weight</i>	33,500 LB / 15,195 KG
<i>draft (maximum)</i>	41" / 105 CM
<i>height (including mast light)</i>	13' 09" / 4.19 M
<i>fuel capacity</i>	251 GAL / 950 L
<i>water capacity</i>	119 GAL / 450 L
<i>black water capacity</i>	37 GAL / 140 L

*The listed performance data is an estimate only based on vessel testing on fresh water with 6 people, full fuel and water and a clean hull bottom. The performance will change based on boating location, vessel loading and maintenance.

The specification measurements are approximate and subject to variance.

GALEON
galeonyachts.us

hts

The 425 HTS is a smaller sibling to the Galeon 485 HTS. We have re-invigorated the ever popular express style yacht by eliminating the need for soft curtains while still providing a truly open yacht. Close it up and enjoy the climate controlled cockpit or open the roof, doors, and windows and you can laugh about the old days of fighting canvas to stay dry from the approaching rain shower.



Entertaining is a breeze with alfresco dining.



Relax in luxury in the spacious and naturally lit salon.



Style meets substance in this amazing new hard top sport model.

Note: Layout and features may vary from shown here due to manufacturer consideration and client customization.

425

STANDARD FEATURES

EXTERIOR

Exterior Upholstery

- Tan & Mocha
- OR
- White & Mocha
- OR
- White & Silver

Hull & Deck Accessories

Bottom Paint

Bow deck rail, 316 stainless steel with side access

Cleats, stainless steel 9 1/2 " [6]

Fiberglass engine room air intakes and stainless steel outputs

Flooring, molded non-skid (bow and side deck)

Handrails, 316 stainless steel (cockpit and side deck)

Horn, electric

Lights, navigation

Mooring System

- Reversible electric anchor winch
- Anchor roller
- Galvanized anchor, 44 lb [20 kg] with 197 ft [60 m] of 5/16" [8 mm] galvanized chain
- Fiberglass deck hatch to self-draining chain locker

Radar mast, stainless steel

Rubrail, PVC with stainless steel insert

Skylight, foredeck with opening rectangular hatch

Spotlight, remote-controlled

Thru-hull Fittings, stainless steel

Windows, bonded tempered glass (hullside) with integrated opening portholes

Windshield, tempered & tinted glass (bonded), single pane forward glass

Windshield defroster

Cockpit

Cupholders

Door, cabin entrance – lockable, handrails, 316 stainless steel

Hardtop, fiberglass with electric sliding sunroof

Hatch, engine room access

Helm Station

- Console Rail, stainless steel
- Compass

- Cupholders, stainless steel
- Helm seat, double wide with flip up bolster and moveable back rest
- Station instruments and controls
 - Digital gauges
 - Switches
 - Alarm, High Water – bilge, cabin
 - Engine Start Panel with Electronic Key Fobs
 - Dual Lever Control, EVC
 - Fire System Monitor
 - Joystick, Volvo Penta
 - Trim control – automatic, Zipwake
 - Outlet, USB
- Steering wheel
- Stereo Remote Control
- Synchronized twin windscreen wipers with front window washing system and defroster outlets

Lighting, indirect LED

Lighting, overhead LED

Outlet, 120V GFI

Self-draining

Seating, port lounge

Seating, U-shape upholstered dinette with convertible backrest

Speakers [2]

Storage, side lockers

Tables [2], adjustable height

Drybar, stainless steel handrail, and storage cabinet

Window, flip up to open interior and exterior

cockpit areas

Stern

Cleats, stainless steel retractable

Door, cockpit access (stainless steel and fiberglass)

Handrail, 316 stainless steel

Lighting, indirect LED

shore power inlet, 240V/50Amp

Shower, fresh water (hot & cold)

Stairs, access to walkaround (molded, port and starboard)

Swim platform, extended with three-step stainless steel swim ladder, stainless steel grab handle and teak decking

Hydraulic opening with engine room access

INTERIOR

Interior Color & Materials

Cabinetry

- Dark Walnut Matte

Wood Flooring

- Striped Walnut

OR

- Misty Grey

Window Treatments

- Curtains

Interior Upholstery

- White

OR

- Beige

Saloon

Carbon Monoxide Detector

Door, access to forward head with full length mirror

Lighting, overhead LED

Lower Accommodation Stairs, wood with stainless steel rail and indirect LED lighting

Outlet, 120V

Porthole, opening tinted with mosquito net

Seating, L-shape sofa with wood dining table

Cockpit with manual blinds

Stereo, Fusion 12V AM/FM with bluetooth module and two speakers

Storage, wall cupboards

Wooden floor

Galley

Cooktop, 120V two-burner induction

Corian worktop and finishings

Extractor Fan

Lighting, overhead LED

Microwave, 120V

Outlet, 120V GFI Protected

Porthole, opening tinted with mosquito net

Refrigerator, 12V with freezer compartment [4.6 ft³ / 130L]

Skylight, cockpit with manual blinds

Storage, general cupboards

Storage, plexiglass cupholders

Wooden floor

Owner's Cabin (Aft)

Carbon Monoxide Detector

Door, private access to owner's head

Berth, queen-size with polyurethane high resilience foam mattress, bed cover and drawer storage below

Flooring, carpet

Headboard, decorative

Lighting, overhead LED

Outlets, 120V (adjacent to bed)

Portholes, opening tinted (port & starboard) with mosquito nets

Seating, single (starboard)

Skylight, foredeck with opening rectangular hatch and manual blinds

Storage, opening cupboard

Storage, large sideboard cabinet

Wardrobe with stainless steel rod

Aft Head

A/C Vent

Bathroom accessories – toothbrush holder, towel hooks, soap dispenser, toilet paper holder

Cabinets, mirrored

Corian countertop with fiberglass bowl and chrome faucet

Extractor fan

Flooring, molded non-slip

Lighting, overhead LED

Outlet, 120V GFI Protected

Porthole, opening tinted with mosquito net

Storage, cupboards

Separate shower area w/ hinged plexiglass doors

- Corian panel
- Chrome shower system
- Storage Cupboard
- Toilet with macerator electric pump

Forward Cabin

Carbon Monoxide Detector

Berth, queen size with polyurethane mattress and storage below

Door to salon, lockable

Flooring, carpet

Lighting, overhead LED

425

STANDARD FEATURES

Outlet, 120V
Portholes, opening tinted with mosquito net
Reading lamps
Storage, upper cabinet
Wardrobe with stainless steel rod and shelving

Forward Head

A/C Vent
Bathroom accessories – toothbrush holder, towel hooks, soap dispenser, toilet paper holder
Corian countertop with fiberglass bowl and chrome faucet
Extractor fan
Flooring, molded non-slip
Lighting, overhead LED
Mirror
Outlet, 120V GFI Protected
Storage, cupboards
Toilet with macerator electric pump
Shower curtain

- Corian panel
- Chrome shower system

SYSTEMS

Power & Drive Systems

2 X Volvo Penta IPS 500 [2X D6-370HP /272 kW] with Joystick

- Duopropellers, bronze
- Electronic Vessel Control System

Hydraulic steering system
Trim control, automatic, Zipwake

Bilge

Automatic / Manual Fire Extinguishing system
Bilge pumps, automatic electric [2] – engine room and aft cabin
Bilge pumps, high water alarm
Common Drain system
Extractor fans [2]
Ladder, stainless steel
Lighting, LED
Sound insulation

Air Conditioning

Air Conditioning System,
Dometic MarineAir [32,000 BTU]

Electrical Systems

DC Electrical System [12V]

- Batteries
- Battery charger / converter, 12V / 80A
- Circuit breakers
- DC Main switchboard

AC Electrical System [120V]

- Shore power, 240V/50Amp
- Circuit breakers
- Generator, Fischer Panda 8 kW diesel with sound shield
- Galvanic Isolator
- Zincs

Fuel System

Fuel tank, 316 stainless steel with air release
Fuel filters, 2 engine, 1 generator
Fuel lines, USCG – Type A-1
Fuel inlet
Fuel stop valve, electromagnetic (emergency button in side cockpit locker)

Fresh Water System

Water tank, stainless steel with air release
Water inlet, stainless steel – port bow deck
Water pump, automatic with filter
Water heater, 11 gal / 40 L
Dockside / Shore Water Connection
Level indicator

Waste System

Black Water Waste System

- Waste Tank, stainless steel with odor filter, water level sensor and air release
- Waste Pump, electric – in engine room
- Level indicator and pump switch in starboard side cockpit locker
- Dockside pumpout fitting – stainless steel (starboard aft deck)
- Overboard waste discharge fitting

OTHER ITEMS

Owner's manual and engine manual

FACTORY OPTIONS

Color & Materials

Cabinetry

- Gloss Walnut OR
- Beach Wood Grey

Wood Flooring

- Misty Grey [Walnut Cabinetry] OR
- Marbled Grey Oak [Beach Wood Grey Cabinetry]

Interior Upholstery

- White OR
- Beige

Comfort Pack

Windshield Shades, front and side
Trip Computer
Raymarine A127 Chartplotter & Fish Finder

- Raymarine Sonar transducer
- Raymarine Digital 4.0 kW Radome Radar

Raymarine VHF Radio with Automatic Identification System [AIS] receiver, remote speaker, and antenna
Raymarine Autopilot with control unit
TV, 32" Samsung® Smart LED with Bluray™ player – saloon

Luxury Pack

Cablemaster
Air Conditioning, cockpit with helm vent - Dometic MarineAir [16,000 BTU]
Refrigerator, cockpit [1.7 ft³ / 49 L]
Foredeck sunpad
Flooring, carpet runners over wooden floor – saloon & galley
TV, 24" Samsung® Smart LED – bow owner's cabin
Pre-wire for audio/video in guest cabin

Individual Option

Teak in cockpit area

LAYOUT



COCKPIT/MAIN DECK

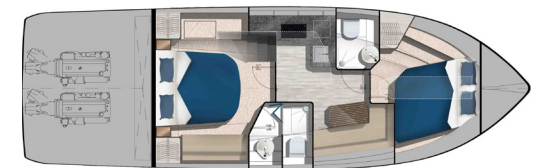

BELOW DECK

The right is reserved to make changes, without notice, at any time, in equipment, materials, and specifications. Drawings, photos, and renderings may show optional equipment.